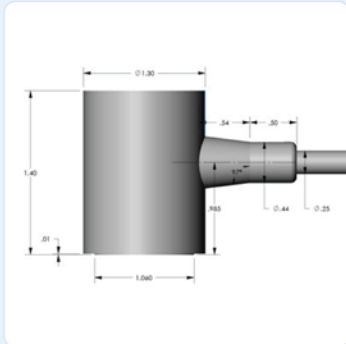

PRODUCT DATA SHEET
ISR1.5 Sensor
Intrinsically Safe Sensor

DESCRIPTION AND FEATURES

The ISR1.5 is a very low resonance frequency sensor that was designed specially to meet Intrinsic Safety (IS) and IP65 environmental requirements. Certified as Intrinsically Safe (IS) for use with our 1276-2 IS Preamplifier and 1276-1 and 1278 IS ASL-C Subsystem, this sensor has a thicker ceramic wear-plate and an epoxy coating completely covering the sensor and cable exit. An IS voltage protection circuit is built into the sensor.

It has an integrated one-meter long differential cable with extruded TPE jacket and a pigtail for connecting into a 1276 or 1278 IS Preamplifier or Subsystem. The sensor has similar frequency response as the R1.5 sensor. Its maximum operating temperature is 125°C.

APPLICATIONS

This sensor is normally selected for structural health monitoring of large-scale concrete structures, geologic structures and for concrete and metal pipeline leak detection applications, where intrinsically safe sensors and instrumentation are required, where large distances between sensors is required and there needs to be some acoustic background noise rejection.

OPERATING SPECIFICATIONS
Dynamic

Peak Sensitivity, Ref V/(m/s).....	87 dB
Operating Frequency Range.....	5-20 KHz
Resonant Frequency.....	15 kHz
Directionality.....	+/- 1.5 dB

Environmental

Temperature Range.....	-45 to 125°C
Shock Limit.....	1,000 g
Waterproof.....	IP66
Completely enclosed crystal for RFI/EMI immunity	

Physical

Dimensions.....	1.32"OD X 1.42"H
.....	33 mm OD X 36 mm H
Weight.....	120 grams with 1 meter cable
Case Material.....	Stainless steel/Epoxy
Face Material.....	Ceramic
Connector.....	Pigtail
Connector Locations.....	Side
Seal.....	Epoxy
Sensor to Preamp Cable (1 meter).....	Integral

Certifications

ATEX Certified, II1, GD, EEx, ia, IIC T4

ORDERING INFORMATION AND ACCESSORIES

ISR1.5.....	ISR1.5
Pre-amplifier.....	1276-2
ASL-4-20 ma Subsystem.....	1276-1
Preamp to System Cable (specify length in 'm').....	1276C
IS Zener Barrier.....	1276B
Other IS Sensors are available with various resonant frequencies.	

Sensors include

NIST Calibration Certificate & Warranty

