

PRODUCT DATA SHEET

S9208 Sensor

Wideband Sensor

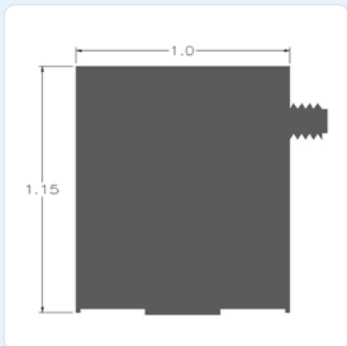

DESCRIPTION AND FEATURES

S9208 is a high fidelity displacement sensor. It is specially designed to provide a flat frequency response to surface acoustic displacement over its entire frequency bandwidth. It is primarily designed for research applications for studying the surface displacement of structures due to different AE modes. It can be used in applications requiring frequency analysis to characterize different kinds of defects. The sensor features a rugged stainless steel body with a microdot connector on the side of the sensor.

APPLICATIONS

The sensor can be used in applications requiring a flat frequency response over the sensor bandwidth and very sensitive to the surface acoustic waves. It can easily be mounted using epoxy.

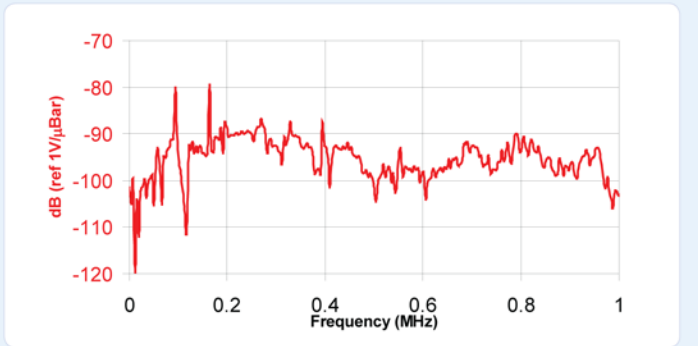

OPERATING SPECIFICATIONS

Dynamic

Peak Sensitivity, Ref V/(m/s).....	45 dB
Peak Sensitivity, Ref V/μbar.....	-85 dB
Operating Frequency Range.....	20-1000 kHz
Resonant Frequency, Ref V/(m/s).....	500 kHz
Resonant Frequency, Ref V/μbar.....	500 kHz
Directionality.....	+/-1.5 dB

Environmental

Temperature Range.....	-54 to 121°C
Shock Limit.....	500 g
Completely enclosed crystal for RFI/EMI immunity	

Physical

Dimensions.....	1"OD X 1"H 25 mm OD X 25 mm H
Weight.....	90 grams
Case Material.....	Stainless Steel
Face Material.....	Stainless Steel
Connector.....	Microdot
Connector Locations.....	Side

ORDERING INFORMATION AND ACCESSORIES

S9208.....	S9208
Cable (specify length in 'XX' m at end of PN).....	1232-1
Pre-amplifier.....	0/2/4, 2/4/6
Preamp to System Cable (specify length in 'm').....	1234-X
Amplifier Subsystems.....	AE2A, AE5A

Sensors include

NIST Calibration Certificate & Warranty

