

**PRODUCT DATA SHEET**

**UT-1000 Sensor**

Wideband Sensor

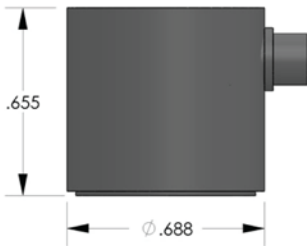

**DESCRIPTION AND FEATURES**

UT-1000 is a wideband sensor with a good frequency response over the range of 100-1000 kHz. This sensor is extremely stable with respect to fluctuations in environmental parameters like temperature and humidity. Its wide frequency bandwidth makes the sensor an ideal candidate for applications involving large number of AE modes. The sensor features a small diameter, microdot connector on the side of the sensor.

**APPLICATIONS**

This sensor is well suited for structural health monitoring of large structures like storage tanks, pipelines etc. Wideband sensors are well suited for research applications where a high fidelity AE response is required. It can be easily mounted using epoxy.

**OPERATING SPECIFICATIONS**

*Dynamic*

Peak Sensitivity, Ref V/(m/s).....	64 dB
Peak Sensitivity, Ref V/ $\mu$ bar.....	-73 dB
Operating Frequency Range.....	100-950 kHz
Resonant Frequency, Ref V/(m/s).....	60 kHz
Resonant Frequency, Ref V/ $\mu$ bar.....	450 kHz
Directionality.....	+/-1.5 dB

*Environmental*

Temperature Range.....	-65 to 177C
Shock Limit.....	500 g
Completely enclosed crystal for RFI/EMI immunity	

*Physical*

Dimensions.....	0.7"OD X 0.65"H
	17.8 mm OD X 16.5 mm H
Weight.....	20 grams
Case Material.....	Stainless Steel
Face Material.....	Ceramic
Connector.....	Microdot
Connector Locations.....	Side

**ORDERING INFORMATION AND ACCESSORIES**

UT-1000.....	UT-1000
Cable (specify length in 'XX' m at end of PN).....	1232-1
Magnetic Hold-Down.....	MHSTD
Preamplifier.....	0/2/4, 2/4/6
Preamp to System Cable (specify length in 'm').....	1234-X
Amplifier Subsystems.....	AE2A or AE5A

*Sensors include*

NIST Calibration Certificate & Warranty

